

**Pignoni a modulo / Spur gears with side hub / Stirnzahnräder mit Nabe**  
**Roues cylindriques avec moyeu lateral / Ruedas dentadas cilindricas con cubo lateral**

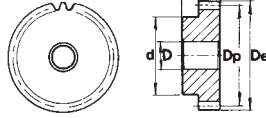

Spessore dente "h" per modulo: **1** = 15 mm  
 Tooth width "h" for module: **1,5** = 17 mm  
 Zahnbreite "h" für Modul: **2** = 20 mm  
 Largeur denture "h" pour forme: **2,5** = 25 mm  
 Ancho dente "h" para modulo: **3** = 30 mm  
**4** = 40 mm  
**5** = 50 mm  
**6** = 60 mm  
**8** = 80 mm



Altezza totale "H" per modulo: **1** = 25 mm  
 Through bore "H" for module: **1,5** = 30 mm  
 Gesamtbreite "H" für Modul: **2** = 35 mm  
 Hauteur totale "H" pour: **2,5** = 40 mm  
 Altura total "H" para Modulo: **3** = 50 mm  
**4** = 60 mm  
**5** = 75 mm  
**6** = 80 mm  
**8** = 110 mm



**Angolo di pressione 20°**  
**Materiale C45E**  
**UNI EN 10083-1**  
 \* Foro di centro

**Pressure angle 20°**  
**Material C45E**  
**UNI EN 10083-1**  
 \* Centering hole

**Eingriffswinkel 20°**  
**Werkstoff C45E**  
**UNI EN 10083-1**  
 \* Zentrier Loch

**Angle de pression 20°**  
**Matière C45E**  
**UNI EN 10083-1**  
 \* Trou de Centrage

**Angulo de presion 20°**  
**Material C45E**  
**UNI EN 10083-1**  
 \* Agujero de Centrado

| Z   | Mod. 1   |     |     |    |    | Mod. 1,5 |       |       |    |    | Mod. 2   |     |     |    |    |
|-----|----------|-----|-----|----|----|----------|-------|-------|----|----|----------|-----|-----|----|----|
|     | cod.     | De  | Dp  | d  | D  | cod.     | De    | Dp    | d  | D  | cod.     | De  | Dp  | d  | D  |
| *12 | PM 26012 | 14  | 12  | 9  | -  | PM 27012 | 21,0  | 18,0  | 14 | 8  | PM 28012 | 28  | 24  | 18 | 10 |
| *13 | PM 26013 | 15  | 13  | 10 | -  | PM 27013 | 22,5  | 19,5  | 14 | 8  | PM 28013 | 30  | 26  | 19 | 10 |
| *14 | PM 26014 | 16  | 14  | 10 | -  | PM 27014 | 24,0  | 21,0  | 17 | 8  | PM 28014 | 32  | 28  | 20 | 10 |
| *15 | PM 26015 | 17  | 15  | 12 | -  | PM 27015 | 25,5  | 22,5  | 18 | 8  | PM 28015 | 34  | 30  | 22 | 10 |
| *16 | PM 26016 | 18  | 16  | 13 | -  | PM 27016 | 27,0  | 24,0  | 20 | 8  | PM 28016 | 36  | 32  | 24 | 10 |
| *17 | PM 26017 | 19  | 17  | 14 | -  | PM 27017 | 28,5  | 25,5  | 20 | 8  | PM 28017 | 38  | 34  | 25 | 10 |
| 18  | PM 26018 | 20  | 18  | 15 | 8  | PM 27018 | 30,0  | 27,0  | 20 | 8  | PM 28018 | 40  | 36  | 25 | 10 |
| 19  | PM 26019 | 21  | 19  | 15 | 8  | PM 27019 | 31,5  | 28,5  | 20 | 8  | PM 28019 | 42  | 38  | 25 | 10 |
| 20  | PM 26020 | 22  | 20  | 16 | 8  | PM 27020 | 33,0  | 30,0  | 25 | 8  | PM 28020 | 44  | 40  | 30 | 10 |
| 21  | PM 26021 | 23  | 21  | 16 | 8  | PM 27021 | 34,5  | 31,5  | 25 | 10 | PM 28021 | 46  | 42  | 30 | 12 |
| 22  | PM 26022 | 24  | 22  | 18 | 8  | PM 27022 | 36,0  | 33,0  | 25 | 10 | PM 28022 | 48  | 44  | 30 | 12 |
| 23  | PM 26023 | 25  | 23  | 18 | 8  | PM 27023 | 37,5  | 34,5  | 25 | 10 | PM 28023 | 50  | 46  | 30 | 12 |
| 24  | PM 26024 | 26  | 24  | 20 | 8  | PM 27024 | 39,0  | 36,0  | 25 | 10 | PM 28024 | 52  | 48  | 35 | 12 |
| 25  | PM 26025 | 27  | 25  | 20 | 8  | PM 27025 | 40,5  | 37,5  | 25 | 10 | PM 28025 | 54  | 50  | 35 | 12 |
| 26  | PM 26026 | 28  | 26  | 20 | 8  | PM 27026 | 42,0  | 39,0  | 30 | 12 | PM 28026 | 56  | 52  | 40 | 12 |
| 27  | PM 26027 | 29  | 27  | 20 | 8  | PM 27027 | 43,5  | 40,5  | 30 | 12 | PM 28027 | 58  | 54  | 40 | 12 |
| 28  | PM 26028 | 30  | 28  | 20 | 8  | PM 27028 | 45,0  | 42,0  | 30 | 12 | PM 28028 | 60  | 56  | 40 | 12 |
| 29  | PM 26029 | 31  | 29  | 20 | 8  | PM 27029 | 46,5  | 43,5  | 30 | 12 | PM 28029 | 62  | 58  | 40 | 14 |
| 30  | PM 26030 | 32  | 30  | 20 | 8  | PM 27030 | 48,0  | 45,0  | 30 | 12 | PM 28030 | 64  | 60  | 40 | 14 |
| 31  | PM 26031 | 33  | 31  | 25 | 10 | PM 27031 | 49,5  | 46,5  | 35 | 12 | PM 28031 | 66  | 62  | 45 | 14 |
| 32  | PM 26032 | 34  | 32  | 25 | 10 | PM 27032 | 51,0  | 48,0  | 35 | 12 | PM 28032 | 68  | 64  | 45 | 14 |
| 33  | PM 26033 | 35  | 33  | 25 | 10 | PM 27033 | 52,5  | 49,5  | 35 | 12 | PM 28033 | 70  | 66  | 45 | 14 |
| 34  | PM 26034 | 36  | 34  | 25 | 10 | PM 27034 | 54,0  | 51,0  | 35 | 12 | PM 28034 | 72  | 68  | 45 | 14 |
| 35  | PM 26035 | 37  | 35  | 25 | 10 | PM 27035 | 55,5  | 52,5  | 35 | 12 | PM 28035 | 74  | 70  | 45 | 14 |
| 36  | PM 26036 | 38  | 36  | 25 | 10 | PM 27036 | 57,0  | 54,0  | 35 | 12 | PM 28036 | 76  | 72  | 45 | 14 |
| 37  | PM 26037 | 39  | 37  | 25 | 10 | PM 27037 | 58,5  | 55,5  | 40 | 12 | PM 28037 | 78  | 74  | 50 | 14 |
| 38  | PM 26038 | 40  | 38  | 25 | 10 | PM 27038 | 60,0  | 57,0  | 40 | 12 | PM 28038 | 80  | 76  | 50 | 14 |
| 39  | PM 26039 | 41  | 39  | 25 | 10 | PM 27039 | 61,5  | 58,5  | 40 | 12 | PM 28039 | 82  | 78  | 50 | 14 |
| 40  | PM 26040 | 42  | 40  | 25 | 10 | PM 27040 | 63,0  | 60,0  | 40 | 12 | PM 28040 | 84  | 80  | 50 | 14 |
| 41  | PM 26041 | 43  | 41  | 30 | 10 | PM 27041 | 64,5  | 61,5  | 50 | 14 | PM 28041 | 86  | 82  | 60 | 16 |
| 42  | PM 26042 | 44  | 42  | 30 | 10 | PM 27042 | 66,0  | 63,0  | 50 | 14 | PM 28042 | 88  | 84  | 60 | 16 |
| 43  | PM 26043 | 45  | 43  | 30 | 10 | PM 27043 | 67,5  | 64,5  | 50 | 14 | PM 28043 | 90  | 86  | 60 | 16 |
| 44  | PM 26044 | 46  | 44  | 30 | 10 | PM 27044 | 69,0  | 66,0  | 50 | 14 | PM 28044 | 92  | 88  | 60 | 16 |
| 45  | PM 26045 | 47  | 45  | 30 | 10 | PM 27045 | 70,5  | 67,5  | 50 | 14 | PM 28045 | 94  | 90  | 60 | 16 |
| 46  | PM 26046 | 48  | 46  | 30 | 10 | PM 27046 | 72,0  | 69,0  | 50 | 14 | PM 28046 | 96  | 92  | 60 | 16 |
| 47  | PM 26047 | 49  | 47  | 30 | 10 | PM 27047 | 73,5  | 70,5  | 50 | 14 | PM 28047 | 98  | 94  | 60 | 16 |
| 48  | PM 26048 | 50  | 48  | 30 | 10 | PM 27048 | 75,0  | 72,0  | 50 | 14 | PM 28048 | 100 | 96  | 70 | 16 |
| 49  | PM 26049 | 51  | 49  | 30 | 10 | PM 27049 | 76,5  | 73,5  | 50 | 14 | PM 28049 | 102 | 98  | 70 | 16 |
| 50  | PM 26050 | 52  | 50  | 30 | 12 | PM 27050 | 78,0  | 75,0  | 50 | 14 | PM 28050 | 104 | 100 | 70 | 16 |
| 51  | PM 26051 | 53  | 51  | 40 | 12 | PM 27051 | 79,5  | 76,5  | 60 | 15 | PM 28051 | 106 | 102 | 70 | 20 |
| 52  | PM 26052 | 54  | 52  | 40 | 12 | PM 27052 | 81,0  | 78,0  | 60 | 15 | PM 28052 | 108 | 104 | 70 | 20 |
| 53  | PM 26053 | 55  | 53  | 40 | 12 | PM 27053 | 82,5  | 79,5  | 60 | 15 | PM 28053 | 110 | 106 | 70 | 20 |
| 54  | PM 26054 | 56  | 54  | 40 | 12 | PM 27054 | 84,0  | 81,0  | 60 | 15 | PM 28054 | 112 | 108 | 70 | 20 |
| 55  | PM 26055 | 57  | 55  | 40 | 12 | PM 27055 | 85,5  | 82,5  | 60 | 15 | PM 28055 | 114 | 110 | 70 | 20 |
| 56  | PM 26056 | 58  | 56  | 40 | 12 | PM 27056 | 87,0  | 84,0  | 60 | 15 | PM 28056 | 116 | 112 | 70 | 20 |
| 57  | PM 26057 | 59  | 57  | 40 | 12 | PM 27057 | 88,5  | 85,5  | 60 | 15 | PM 28057 | 118 | 114 | 70 | 20 |
| 58  | PM 26058 | 60  | 58  | 40 | 12 | PM 27058 | 90,0  | 87,0  | 60 | 15 | PM 28058 | 120 | 116 | 70 | 20 |
| 59  | PM 26059 | 61  | 59  | 40 | 12 | PM 27059 | 91,5  | 88,5  | 60 | 15 | PM 28059 | 122 | 118 | 70 | 20 |
| 60  | PM 26060 | 62  | 60  | 40 | 12 | PM 27060 | 93,0  | 90,0  | 60 | 15 | PM 28060 | 124 | 120 | 70 | 20 |
| 61  | PM 26061 | 63  | 61  | 50 | 12 | PM 27061 | 94,5  | 91,5  | 70 | 20 | PM 28061 | 126 | 122 | 80 | 20 |
| 62  | PM 26062 | 64  | 62  | 50 | 12 | PM 27062 | 96,0  | 93,0  | 70 | 20 | PM 28062 | 128 | 124 | 80 | 20 |
| 63  | PM 26063 | 65  | 63  | 50 | 12 | PM 27063 | 97,5  | 94,5  | 70 | 20 | PM 28063 | 130 | 126 | 80 | 20 |
| 64  | PM 26064 | 66  | 64  | 50 | 12 | PM 27064 | 99,0  | 96,0  | 70 | 20 | PM 28064 | 132 | 128 | 80 | 20 |
| 65  | PM 26065 | 67  | 65  | 50 | 12 | PM 27065 | 100,5 | 97,5  | 70 | 20 | PM 28065 | 134 | 130 | 80 | 20 |
| 66  | PM 26066 | 68  | 66  | 50 | 12 | PM 27066 | 102,0 | 99,0  | 70 | 20 | PM 28066 | 136 | 132 | 80 | 20 |
| 67  | PM 26067 | 69  | 67  | 50 | 12 | PM 27067 | 103,5 | 100,5 | 70 | 20 | PM 28067 | 138 | 134 | 80 | 20 |
| 68  | PM 26068 | 70  | 68  | 50 | 12 | PM 27068 | 105,0 | 102,0 | 70 | 20 | PM 28068 | 140 | 136 | 80 | 20 |
| 69  | PM 26069 | 71  | 69  | 50 | 12 | PM 27069 | 106,5 | 103,5 | 70 | 20 | PM 28069 | 142 | 138 | 80 | 20 |
| 70  | PM 26070 | 72  | 70  | 50 | 12 | PM 27070 | 108,0 | 105,0 | 70 | 20 | PM 28070 | 144 | 140 | 80 | 20 |
| 72  | PM 26072 | 74  | 72  | 50 | 12 | PM 27072 | 111,0 | 108,0 | 80 | 20 | PM 28072 | 148 | 144 | 80 | 20 |
| 75  | PM 26075 | 77  | 75  | 50 | 12 |          |       |       |    |    |          |     |     |    |    |
| 76  | PM 26076 | 78  | 76  | 50 | 12 |          |       |       |    |    |          |     |     |    |    |
| 78  |          |     |     |    |    |          |       |       |    |    |          |     |     |    |    |
| 80  | PM 26080 | 82  | 80  | 50 | 12 |          |       |       |    |    | PM 28078 | 160 | 156 | 80 | 20 |
| 90  | PM 26090 | 92  | 90  | 50 | 12 |          |       |       |    |    |          |     |     |    |    |
| 100 | PM 26100 | 102 | 100 | 60 | 12 |          |       |       |    |    |          |     |     |    |    |

| Z  | Mod. 2,5 |                |                |     |    | Mod. 3   |                |                |     |    | Mod. 4   |                |                |     |    |
|----|----------|----------------|----------------|-----|----|----------|----------------|----------------|-----|----|----------|----------------|----------------|-----|----|
|    | cod.     | D <sub>e</sub> | D <sub>p</sub> | d   | D  | cod.     | D <sub>e</sub> | D <sub>p</sub> | d   | D  | cod.     | D <sub>e</sub> | D <sub>p</sub> | d   | D  |
| 10 |          |                |                |     |    |          |                |                |     |    |          |                |                |     |    |
| 12 | PM 29012 | 35,0           | 30,0           | 22  | 10 | PM 30012 | 42             | 36             | 25  | 12 | PM 31010 | 48             | 40             | 26  | 10 |
| 13 | PM 29013 | 37,5           | 32,5           | 25  | 10 | PM 30013 | 45             | 39             | 25  | 12 | PM 31012 | 56             | 48             | 35  | 14 |
| 14 | PM 29014 | 40,0           | 35,0           | 28  | 10 | PM 30014 | 48             | 42             | 30  | 12 | PM 31013 | 60             | 52             | 40  | 14 |
| 15 | PM 29015 | 42,5           | 37,5           | 30  | 10 | PM 30015 | 51             | 45             | 35  | 12 | PM 31014 | 64             | 56             | 45  | 14 |
| 16 | PM 29016 | 45,0           | 40,0           | 32  | 12 | PM 30016 | 54             | 48             | 38  | 15 | PM 31015 | 68             | 60             | 45  | 14 |
| 17 | PM 29017 | 47,5           | 42,5           | 35  | 12 | PM 30017 | 57             | 51             | 42  | 15 | PM 31016 | 72             | 64             | 50  | 15 |
| 18 | PM 29018 | 50,0           | 45,0           | 35  | 12 | PM 30018 | 60             | 54             | 45  | 15 | PM 31017 | 76             | 68             | 50  | 15 |
| 19 | PM 29019 | 52,5           | 47,5           | 35  | 12 | PM 30019 | 63             | 57             | 45  | 15 | PM 31018 | 80             | 72             | 50  | 15 |
| 20 | PM 29020 | 55,0           | 50,0           | 40  | 14 | PM 30020 | 66             | 60             | 45  | 15 | PM 31019 | 84             | 76             | 60  | 15 |
| 21 | PM 29021 | 57,5           | 52,5           | 40  | 14 | PM 30021 | 69             | 63             | 45  | 15 | PM 31020 | 88             | 80             | 60  | 15 |
| 22 | PM 29022 | 60,0           | 55,0           | 45  | 14 | PM 30022 | 72             | 66             | 50  | 15 | PM 31021 | 92             | 84             | 70  | 20 |
| 23 | PM 29023 | 62,5           | 57,5           | 45  | 14 | PM 30023 | 75             | 69             | 50  | 15 | PM 31022 | 96             | 88             | 70  | 20 |
| 24 | PM 29024 | 65,0           | 60,0           | 45  | 14 | PM 30024 | 78             | 72             | 50  | 16 | PM 31023 | 100            | 92             | 75  | 20 |
| 25 | PM 29025 | 67,5           | 62,5           | 50  | 14 | PM 30025 | 81             | 75             | 60  | 16 | PM 31024 | 104            | 96             | 75  | 20 |
| 26 | PM 29026 | 70,0           | 65,0           | 50  | 14 | PM 30026 | 84             | 78             | 60  | 16 | PM 31025 | 108            | 100            | 75  | 20 |
| 27 | PM 29027 | 72,5           | 67,5           | 50  | 14 | PM 30027 | 87             | 81             | 60  | 16 | PM 31026 | 112            | 104            | 75  | 20 |
| 28 | PM 29028 | 75,0           | 70,0           | 50  | 14 | PM 30028 | 90             | 84             | 60  | 16 | PM 31027 | 116            | 108            | 75  | 20 |
| 29 | PM 29029 | 77,5           | 72,5           | 50  | 14 | PM 30029 | 93             | 87             | 60  | 16 | PM 31028 | 120            | 112            | 75  | 20 |
| 30 | PM 29030 | 80,0           | 75,0           | 55  | 16 | PM 30030 | 96             | 90             | 60  | 16 | PM 31029 | 124            | 116            | 75  | 20 |
| 31 | PM 29031 | 82,5           | 77,5           | 55  | 16 | PM 30031 | 99             | 93             | 70  | 20 | PM 31030 | 128            | 120            | 75  | 20 |
| 32 | PM 29032 | 85,0           | 80,0           | 55  | 16 | PM 30032 | 102            | 96             | 70  | 20 | PM 31031 | 132            | 124            | 80  | 20 |
| 33 | PM 29033 | 87,5           | 82,5           | 55  | 16 | PM 30033 | 105            | 99             | 70  | 20 | PM 31032 | 136            | 128            | 80  | 20 |
| 34 | PM 29034 | 90,0           | 85,0           | 55  | 16 | PM 30034 | 108            | 102            | 70  | 20 | PM 31033 | 140            | 132            | 80  | 20 |
| 35 | PM 29035 | 92,5           | 87,5           | 60  | 16 | PM 30035 | 111            | 105            | 70  | 20 | PM 31034 | 144            | 136            | 80  | 20 |
| 36 | PM 29036 | 95,0           | 90,0           | 60  | 16 | PM 30036 | 114            | 108            | 70  | 20 | PM 31035 | 148            | 140            | 80  | 20 |
| 37 | PM 29037 | 97,5           | 92,5           | 60  | 16 | PM 30037 | 117            | 111            | 80  | 20 | PM 31036 | 152            | 144            | 80  | 20 |
| 38 | PM 29038 | 100,0          | 95,0           | 60  | 16 | PM 30038 | 120            | 114            | 80  | 20 | PM 31037 | 156            | 148            | 80  | 20 |
| 39 | PM 29039 | 102,5          | 97,5           | 60  | 16 | PM 30039 | 123            | 117            | 80  | 20 | PM 31038 | 160            | 152            | 80  | 25 |
| 40 | PM 29040 | 105,0          | 100,0          | 70  | 20 | PM 30040 | 126            | 120            | 80  | 20 | PM 31039 | 164            | 156            | 80  | 25 |
| 41 | PM 29041 | 107,5          | 102,5          | 70  | 20 | PM 30041 | 129            | 123            | 90  | 20 | PM 31040 | 168            | 160            | 80  | 25 |
| 42 | PM 29042 | 110,0          | 105,0          | 70  | 20 | PM 30042 | 132            | 126            | 90  | 20 |          |                |                |     |    |
| 43 | PM 29043 | 112,5          | 107,5          | 70  | 20 | PM 30043 | 135            | 129            | 90  | 20 |          |                |                |     |    |
| 44 | PM 29044 | 115,0          | 110,0          | 70  | 20 | PM 30044 | 138            | 132            | 90  | 20 |          |                |                |     |    |
| 45 | PM 29045 | 117,5          | 112,5          | 70  | 20 | PM 30045 | 141            | 135            | 90  | 20 | PM 31045 | 188            | 180            | 80  | 25 |
| 46 | PM 29046 | 120,0          | 115,0          | 70  | 20 | PM 30046 | 144            | 138            | 90  | 20 |          |                |                |     |    |
| 47 | PM 29047 | 122,5          | 117,5          | 80  | 20 | PM 30047 | 147            | 141            | 90  | 20 |          |                |                |     |    |
| 48 | PM 29048 | 125,0          | 120,0          | 80  | 20 | PM 30048 | 150            | 144            | 100 | 20 | PM 31048 | 200            | 192            | 80  | 25 |
| 49 | PM 29049 | 127,5          | 122,5          | 80  | 20 | PM 30049 | 153            | 147            | 100 | 20 |          |                |                |     |    |
| 50 | PM 29050 | 130,0          | 125,0          | 80  | 20 | PM 30050 | 156            | 150            | 100 | 20 | PM 31050 | 208            | 200            | 80  | 25 |
| 51 | PM 29051 | 132,5          | 127,5          | 90  | 20 |          |                |                |     |    |          |                |                |     |    |
| 52 | PM 29052 | 135,0          | 130,0          | 90  | 20 |          |                |                |     |    |          |                |                |     |    |
| 53 | PM 29053 | 137,5          | 132,5          | 90  | 20 |          |                |                |     |    |          |                |                |     |    |
| 54 | PM 29054 | 140,0          | 135,0          | 90  | 20 | PM 30054 | 168            | 162            | 100 | 20 |          |                |                |     |    |
| 55 | PM 29055 | 142,5          | 137,5          | 90  | 20 | PM 30055 | 171            | 165            | 100 | 20 |          |                |                |     |    |
| 56 | PM 29056 | 145,0          | 140,0          | 100 | 20 | PM 30056 | 174            | 168            | 100 | 20 | PM31056  | 232            | 224            | 80  | 25 |
| 57 | PM 29057 | 147,5          | 142,5          | 100 | 20 | PM 30057 | 177            | 171            | 100 | 20 |          |                |                |     |    |
| 58 | PM 29058 | 150,0          | 145,0          | 100 | 20 |          |                |                |     |    |          |                |                |     |    |
| 59 | PM 29059 | 152,5          | 147,5          | 100 | 20 |          |                |                |     |    |          |                |                |     |    |
| 60 | PM 29060 | 155,0          | 150,0          | 100 | 20 | PM 30060 | 186            | 180            | 100 | 20 | PM 31060 | 248            | 240            | 100 | 25 |
| 62 | PM 29062 | 160,0          | 155,0          | 100 | 20 | PM 30062 | 192            | 186            | 100 | 20 |          |                |                |     |    |
| 63 | PM 29063 | 162,5          | 157,5          | 100 | 20 |          |                |                |     |    |          |                |                |     |    |
| 65 | PM 29065 | 167,5          | 162,5          | 100 | 20 | PM 30065 | 201            | 195            | 100 | 20 | PM 31065 | 268            | 260            | 100 | 25 |
| 67 | PM 29067 | 172,5          | 167,5          | 100 | 20 |          |                |                |     |    |          |                |                |     |    |
| 70 | PM 29070 | 180,0          | 175,0          | 100 | 20 |          |                |                |     |    |          |                |                |     |    |

| Z  | Mod. 5   |                |                |     |    | Mod. 6   |                |                |     |    | Mod. 8   |                |                |     |    |
|----|----------|----------------|----------------|-----|----|----------|----------------|----------------|-----|----|----------|----------------|----------------|-----|----|
|    | cod.     | D <sub>e</sub> | D <sub>p</sub> | d   | D  | cod.     | D <sub>e</sub> | D <sub>p</sub> | d   | D  | cod.     | D <sub>e</sub> | D <sub>p</sub> | d   | D  |
| 12 | PM 32012 | 70             | 60             | 45  | 16 | PM 34012 | 84             | 72             | 54  | 20 | PM39012  | 112            | 96             | 56  | 20 |
| 13 | PM 32013 | 75             | 65             | 50  | 16 |          |                |                |     |    |          |                |                |     |    |
| 14 | PM 32014 | 80             | 70             | 55  | 20 | PM 34014 | 96             | 84             | 65  | 20 |          |                |                |     |    |
| 15 | PM 32015 | 85             | 75             | 60  | 20 | PM 34015 | 102            | 90             | 70  | 20 | PM 39015 | 136            | 120            | 90  | 25 |
| 16 | PM 32016 | 90             | 80             | 65  | 20 | PM 34016 | 108            | 96             | 75  | 20 |          |                |                |     |    |
| 17 | PM 32017 | 95             | 85             | 70  | 20 |          |                |                |     |    |          |                |                |     |    |
| 18 | PM 32018 | 100            | 90             | 70  | 20 | PM 34018 | 120            | 108            | 80  | 20 | PM 39018 | 160            | 144            | 100 | 25 |
| 19 | PM 32019 | 105            | 95             | 70  | 20 |          |                |                |     |    |          |                |                |     |    |
| 20 | PM 32020 | 110            | 100            | 80  | 20 | PM 34020 | 132            | 120            | 90  | 20 | PM 39020 | 176            | 160            | 120 | 30 |
| 21 | PM 32021 | 115            | 105            | 80  | 20 |          |                |                |     |    |          |                |                |     |    |
| 22 | PM 32022 | 120            | 110            | 80  | 25 |          |                |                |     |    |          |                |                |     |    |
| 23 | PM 32023 | 125            | 115            | 90  | 25 | PM 34023 | 150            | 138            | 110 | 25 |          |                |                |     |    |
| 24 | PM 32024 | 130            | 120            | 90  | 25 | PM 34024 | 156            | 144            | 110 | 25 | PM 39024 | 208            | 192            | 150 | 30 |
| 25 | PM 32025 | 135            | 125            | 90  | 25 | PM 34025 | 162            | 150            | 110 | 25 | PM 39025 | 216            | 200            | 150 | 30 |
| 26 | PM 32026 | 140            | 130            | 100 | 25 |          |                |                |     |    |          |                |                |     |    |
| 27 | PM 32027 | 145            | 135            | 100 | 25 |          |                |                |     |    |          |                |                |     |    |
| 28 | PM 32028 | 150            | 140            | 100 | 25 |          |                |                |     |    |          |                |                |     |    |
| 29 | PM 32029 | 155            | 145            | 100 | 25 |          |                |                |     |    | PM 39028 | 240            | 224            | 170 | 30 |
| 30 | PM 32030 | 160            | 150            | 100 | 25 |          |                |                |     |    | PM 39030 | 256            | 240            | 190 | 30 |
| 32 | PM 32032 | 170            | 160            | 110 | 25 |          |                |                |     |    |          |                |                |     |    |
| 36 | PM 32036 | 190            | 180            | 110 | 25 |          |                |                |     |    |          |                |                |     |    |
| 38 | PM 32038 | 200            | 190            | 110 | 30 |          |                |                |     |    |          |                |                |     |    |
| 40 | PM 32040 | 210            | 200            | 110 | 30 |          |                |                |     |    |          |                |                |     |    |
| 42 | PM 32042 | 220            | 210            | 120 | 25 | PM 34040 | 252            | 240            | 120 | 25 |          |                |                |     |    |
| 55 | PM 32055 | 285            | 275            | 120 | 30 |          |                |                |     |    |          |                |                |     |    |
| 60 | PM 32060 | 310            | 300            | 120 | 30 |          |                |                |     |    |          |                |                |     |    |